



PARK ROAD LONDON, NW8

£3,502 PER MONTH

A two bedroom apartment in a portered building near Regents Park and LBS. The property comprises of a large and bright reception room, fully fitted kitchen, two double bedrooms and a family bathroom.

The property is perfectly located just opposite the green open spaces of Regent's Park while the shops and amenities of St John's Wood are only a short walk away.

PMP | INTERNATIONAL

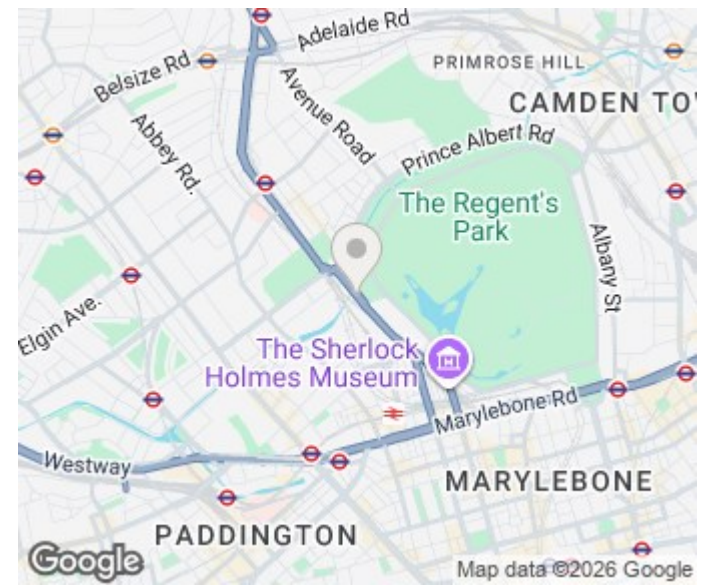
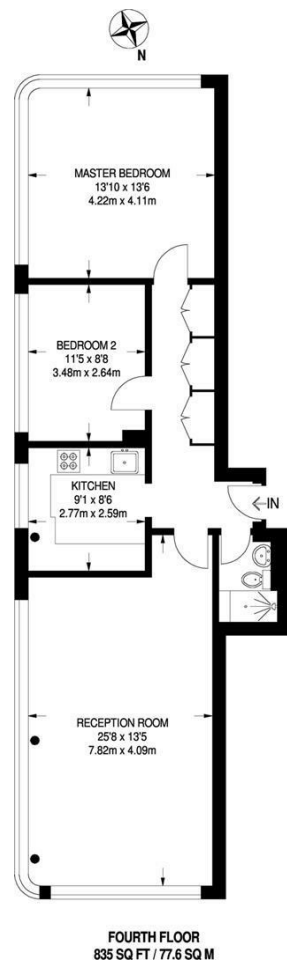

Energy Efficiency Rating		Current	Potential
Very energy efficient - lower running costs			
(92 plus) A			
(81-91) B			
(69-80) C		75	79
(55-68) D			
(39-54) E			
(21-38) F			
(1-20) G			
Not energy efficient - higher running costs			
England & Wales		EU Directive 2002/91/EC	

Agents Note: Whilst every care has been taken to prepare these particulars, they are for guidance purposes only. All measurements are approximate and are for general guidance purposes only and whilst every care has been taken to ensure their accuracy, they should not be relied upon and potential buyers/tenants are advised to recheck the measurements

London
PMP International
94 Belsize Lane
Belsize Park
London
NW3 5BE

020 7701 2878
info@pmpi.co.uk
www.pmpi.co.uk

PMP | INTERNATIONAL